

## Operator Manual

### NB100 Electric-Scrubber



#### **WARNING**

Do not use the scrubber before reading and understanding these operating instructions.

#### **NOTE:**

- Please check the designation of your present type at the last page of this document as well as on the ID-plate.
- Keep this manual for future reference.

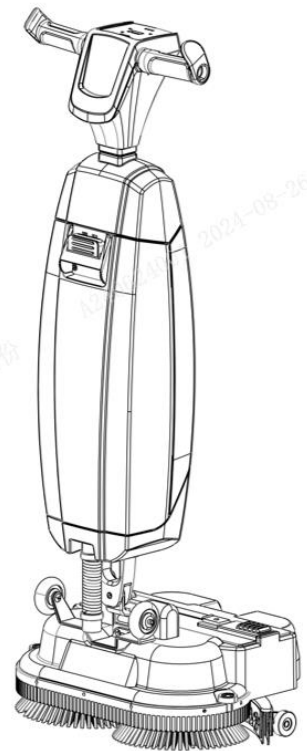

Version 07/2025

NB100-SMS-003

---

## CONTENTS

<b>Introduction .....</b>	<b>2</b>
<b>Intended Use.....</b>	<b>2</b>
<b>Environment Protection .....</b>	<b>2</b>
<b>Machine Data Label.....</b>	<b>2</b>
<b>Uncrate the Machine .....</b>	<b>3</b>
<b>Reading Guide .....</b>	<b>3</b>
<b>Safety .....</b>	<b>5</b>
Important Safety Instructions.....	5
Safety Labels .....	4
<b>Know your Machine .....</b>	<b>7</b>
Overview of Appearance .....	7
Top Handle.....	8
<b>Operation.....</b>	<b>9</b>
Fill the cleaning solution tank .....	9
Operation procedure .....	10
At the job site .....	11
Assist in the use of sales shafts.....	11
Vertical pin shaft usage .....	12
Stopping the Machine .....	14
<b>Cleaning and storage.....</b>	<b>14</b>
<b>Cleaning the tanks.....</b>	<b>14</b>
<b>Before storage.....</b>	<b>15</b>
<b>Store in an upright position.....</b>	<b>15</b>
<b>Transportation.....</b>	<b>15</b>
<b>Assembly and installation.....</b>	<b>15</b>
<b>Charging port location .....</b>	<b>16</b>
<b>Maintenance .....</b>	<b>17</b>
Brushes Replacement .....	17
Squeegee Maintenance .....	17
Troubleshooting .....	20
<b>Specifications.....</b>	<b>21</b>

---

## Introduction

This manual is only intended for user and provides necessary information for operating the machine. It contains the safety, operations, maintenance and the specifications of the machine.



**CAUTION** Read all instructions before operating or maintaining this machine.

The machine will provide the optimal service, if:

- Operate the machine properly.
- Maintain the machine regularly according to the maintenance instructions.
- Maintain the machine with manufacturer supplied or equivalent parts.

If you have questions about the instructions and explanations of this manual, please contact NOBLELIFT.

## Intended Use

NB100 is an industrial auto cleaning machine that cleans faster, cleaner, safer, greener and is better for everyone. The NB100 compact design allows you to clean right to the edge and under obstacles, minimizing manual scrubbing. The battery-operated NB100 is equipped with two counter-rotating brushes that provide a deep scrub and a great cleaning result. The NB100 significantly reduces the amount of water and chemicals needed which both leads to a greener result and reduces the risk of slippery floors. The NB100 is a specialized machine for scrubbing hard floor surfaces. You can use any type of water-based scrubbing detergent.

## Environment Protection



Please dispose of packaging materials and used machine components such as batteries in an environmentally safe way according to your local waste disposal regulations.



## Machine Data Label

The model and serial number of the machine are shown on the nameplate which is located at the rear of the machine. This information is needed when ordering repair parts for the machine. Please note the machine model and serial number as below:

Model: \_\_\_\_\_

Serial Number: \_\_\_\_\_

Data of Purchase: \_\_\_\_\_





## Uncrate the Machine





When the machine is delivered, please check the packaging and machine carefully for any damage. If there is any damage, report to the carrier immediately. Contact the local dealer or NOBLELIFT directly for missing items.

**Notice:** Please fully charge the machine before first use.

## Reading Guide

The following symbols and terms are used throughout this manual to alert the reader to safety issues and important information:

SYMBOL	TERM	EXPLANATION
	<b>WARNING</b>	Indicates a hazardous situation which, if the safety instructions are not followed, can lead to injuries of the operator or bystanders and light or moderate damage to the product or the environment.
	<b>CAUTION</b>	Indicates a hazardous situation which, if the safety instructions are not followed, can lead to light and or moderate damage to the product or the environment.
	<b>ATTENTION</b>	Indicated a liability situation, where the manufacturer or its partners and affiliates cannot be held accountable for damages caused by non-compliance.

	<b>STRONG MAGNET</b>	Indicates the machine contains strong magnets. These can cause pacemakers to stop working or cause electronic data to be damaged, such as information stored on access passes.
	<b>PACEMAKER</b>	Indicates operator and maintenance crew wearing pacemakers should keep a minimal distance of 6in/15cm, in this specific case operators may not use the machine as a backpack.
	<b>BATTERIES</b>	Indicates a battery-operated machine, batteries must be charged according to the instructions in the separate class I battery charger user manual. Batteries must be disposed of according to your local laws and regulations.
	<b>SLIPPERY SURFACE</b>	Indicates the machine can cause floors to become slippery. In the work place, advised to place slippery surface signs in these areas.

---

# Safety

## Important Safety Instructions

### Save These Instructions

**FOR SAFETY:** To identify actions which must be followed for safe operation of equipment.

#### **WARNING: Non-intended use of the product**

- Never operate the NB100 near flammable dusts, liquids or vapors.
- Never operate the NB100 when flammable or poisonous liquids like gasoline, oil acids, or other volatile Substances are on the floor.
- DO NOT fill the NB100 with any flammable detergent. Only use the water-based cleaning solutions.
- Do not use water that exceeds 113 °F/45°C. Using water above this temperature will void the tank warranty.
- Do not use cleaning solutions with pH below 3 or above 11 in order to prevent damage to sensitive components.
- Do not use the NB100 outdoors or on uneven surfaces.
- Do not operate this NB100 over electrical floor outlets in order to avoid electrical shock.
- Do not use the NB100 as stepladder or platform.
- Do not use the NB100 outside in order to avoid damage to electronic components.
- If the supply cord of the manual charger is damaged, it must be replaced with a cord provided by NOBLELIFT or by a qualified service agent in order to avoid hazards.

 **WARNING:** Each NB100 is guaranteed to operate for one year. The wear on brushes and squeegee heavily depends on the roughness of the surface. They need to be checked regularly. ensure proper and safe operation throughout the life of the NB100, the machine must be checked every 500 hours by an authorized partner.

#### **FOR SAFETY:**

##### **Risks during operation:**

1. Dress safely
  - Unless trained and authorized. Do not wear a necktie, scarf, or any loose or dangling clothing or jewelry while operating the NB100, these can tangle in rotating parts, causing serious injury or death.
2. Mark the job site
  - The NB100 is designed to leave a dry floor without slippery patches, no additional drying is required. When running the NB100 with the vacuum function OFF please mark the job site with a wet floor marker.
  - Marking the job site with a wet floor marker is not required when using the vacuum function of the NB100. Unless this is a mandatory work safety requirement by local law. When unsure: mark the job site to warn passersby.
3. Careful when parking
  - Do not park the NB100 on ramps or slopes. Always Park the NB100 on a level, hard surface.

##### **Risks after operation:**

1. Remove battery pack
  - It is best practice to remove the battery before executing any cleaning or maintenance task, or before Storage.
2. Machine orientation
  - Always keep the body of the NB100 in an upright (park) position when replacing brushes or squeegee.
3. Transport and Storage
  - Always keep the body of the NB100 in an upright position when filling the cleaning solution tank or inserting the batteries.
  - Before storage or transport, drain the machine and remove the batteries after each use.
4. Park position
  - Make sure the vacuum hose is pushed back into the machine so it cannot get squeezed.
  - Crouch down and hold the handle with one hand while holding the scrub deck with your other hand.
  - Lift the scrub deck slowly until it stands upright on the front wheels. Guide the body towards the scrub deck until snaps into a resting position.

### **Sweep before scrub:**

- Remove objects from the floor that can be propelled by the rotating brushes.

### **Brush condition**

- Make sure to check the condition of the brush before use. Change the brush only when the machine is turned off in a park position

### **Machine orientation**

- Always keep the body of the E100 in an upright position when cleaning fluid or batteries are inserted.

### **Strong**



- Please be aware of the integrated magnets that hold the fluid tanks in place.

### **Warning**









- Operators and maintenance crew wearing pacemakers should keep a minimal distance of 6 in/15 cm.

### **Battery**



- Always use the automatic battery charger provided by the manufacturer.
- During normal operation, the 36V battery causes no Safety hazard on their own. During normal operation, the 36V battery causes no Safety hazard on their own.

### Safety Labels

	Caution: watch your hand to avoid damage.
	Do not step on the place, may cause damage to the machine.
	Do not touch the device.
	This is the Class 1 laser device and it's safe for the eyes.
	Disposal
	Do not throw used machine components to the bin.



## Know your Machine

### Overview of Appearance

The NB100 consists of two main parts:

1. The body that contains the motors (one vacuum motor, two brush motors), cleaning solution tank, recovery tank, handle and control panel with 3 functional buttons & one power display window).
2. The scrub deck that contains the brushes and squeegee. The NB100 can be folded into a park position; this is recommended for storage.

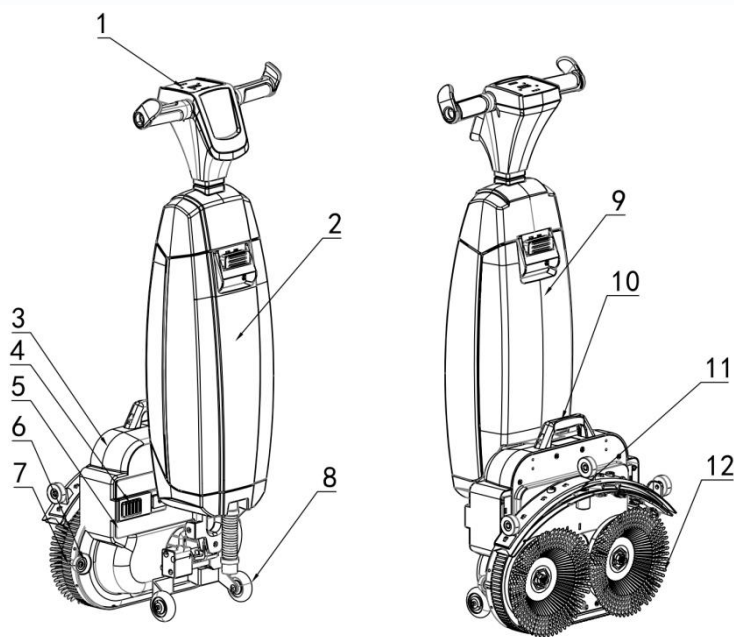

**FIG.1**

- |                          |                       |
|--------------------------|-----------------------|
| 1. Top handle            | 7. Surrounding fence  |
| 2. Recovery tank         | 8. Castor wheels      |
| 3. Scrub deck            | 9. Solution tank      |
| 4. Battery pack box knob | 10. Carrying handle   |
| 5. Battery pack box      | 11. Squeegee assembly |
| 6. Bumper wheels         | 12. Brushes           |

### Top Handle

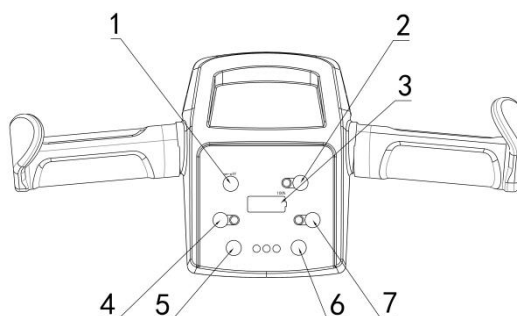

**FIG.2**

- |                                   |  |
|-----------------------------------|--|
| 1. Power switch (ON/OFF)          | 4. Vacuum on/off button                  |
| 2. Water pump on/off button       | ➤ green light flash - recovery tank full |
| ➤ green light - small water level | 5. Brush on/off button                   |
| ➤ Blue light-big water level      | 6. Speed Adjustment - for low "-"        |
| ➤ Light flash-solution tank empty | 7. Speed Adjustment - for low "+"        |
| 3. Battery indicator              |  |

## Operation

The main purpose of this chapter is to provide the necessary operating instructions for the operators.

**Note:** Charge the battery pack when it is correctly connected in the machine. Make sure the battery pack is charged monthly.

### Fill the cleaning solution tank

1. Remove the stopper.
2. Pour in a maximum of 18gal/4L of cleaning fluid.
3. Replace the stopper and make sure it seals tight.
4. Put the NB100 in park position.
5. Put the tank on the NB100 with the valve first.
6. Press the tank downward to break the valve seal.
7. Push the tank into place until you hear a "click".
8. Clean your hands afterwards.

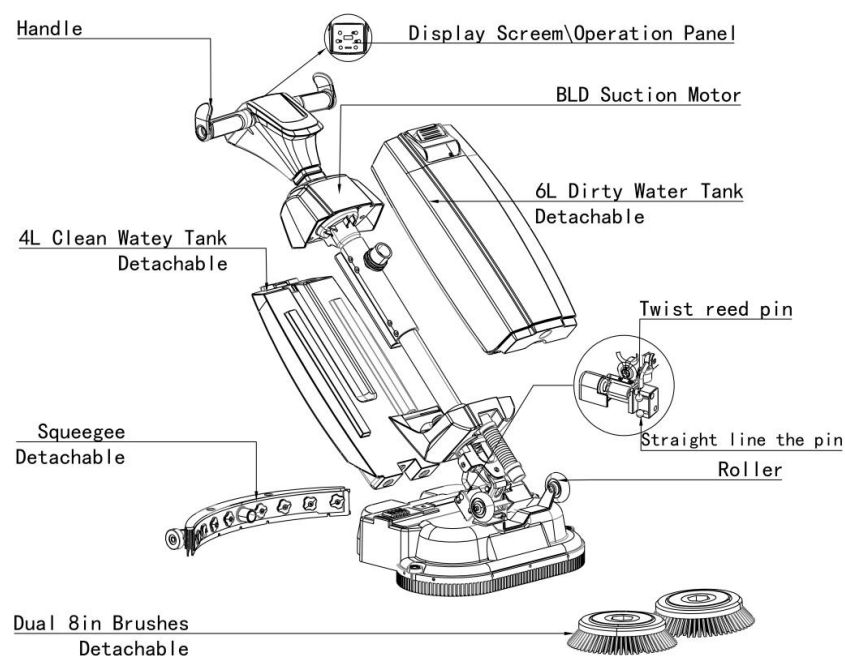

**FIG.3**

**Note:** Check the brushes and squeegee for wear and tear. During operation, the battery indicator on the control panel shows the amount of power left. It is not recommended to use the

battery when charged below 40%. If the floor is quite flat, you can also rely on the castor wheels for easy movement.

### Operation procedure

To move the NB100 from one location to another one in a building:

1. Put the NB100 in park position as shown in FIG.4.
2. Hold the handle with one hand as shown in FIG.5.
3. Walk slowly and pay extra attention if you pull the NB100 over obstacles.
4. To lift the NB100 over obstacles, always use two hands. Hold the handle with one hand. Lift the scrub deck with the other hand.

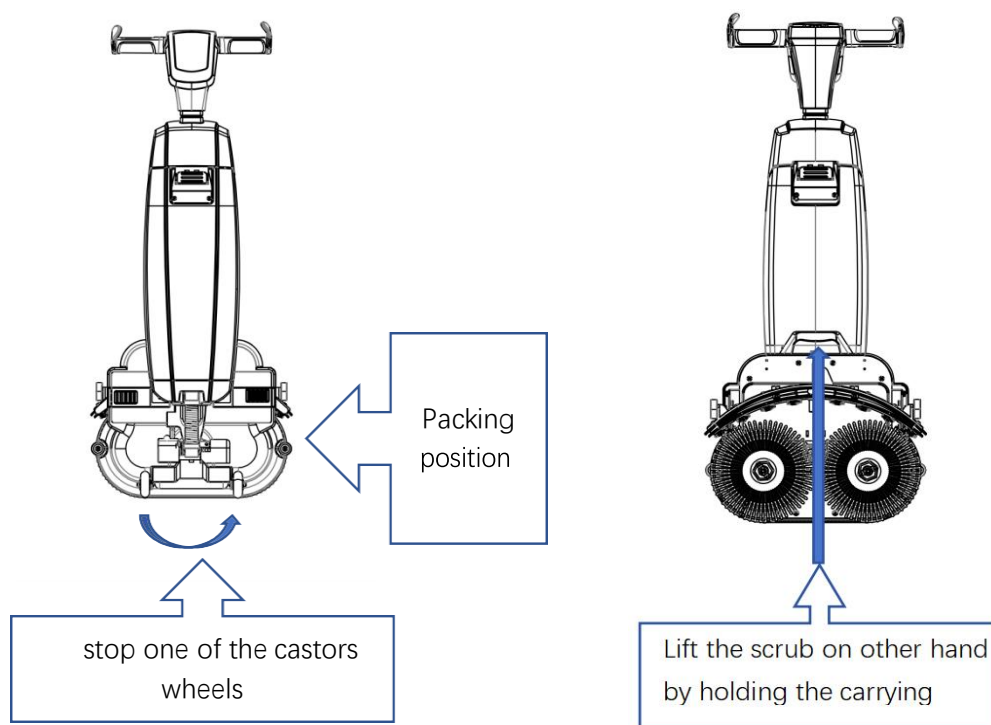

**FIG.4**

**Note:** If the floor is quite flat, you can also rely on the castor wheels for easy movement. It is in the park position and get the main body tilted forward properly, then holding the properly, then holding the top.

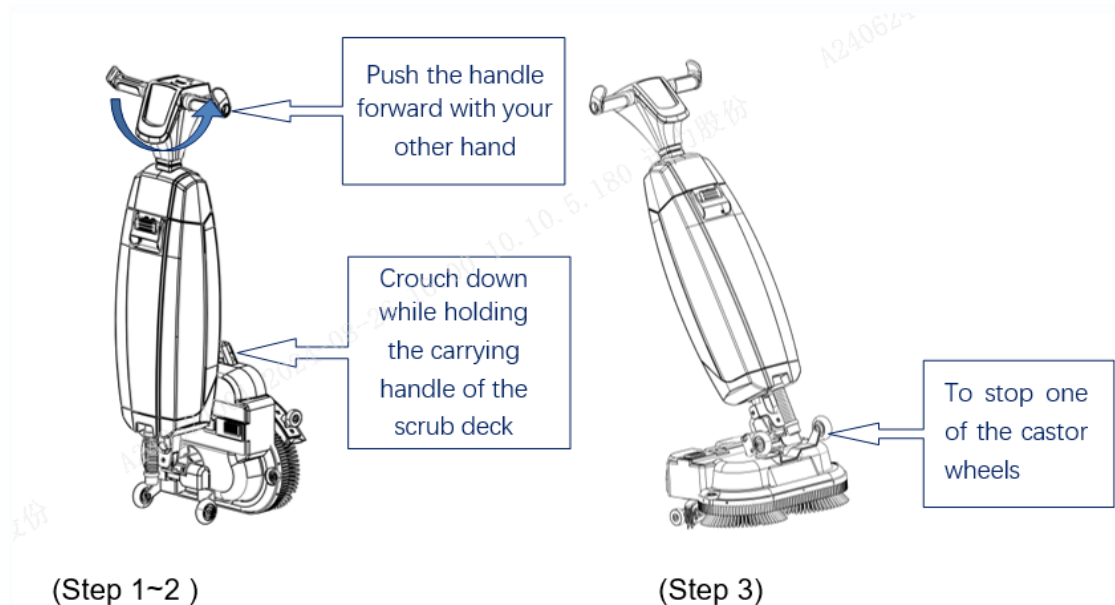

FIG.5

**⚠ WARNING:** Never push down the scrub deck with your foot.

### At the job site

1. Crouch down while holding the carrying handle of the scrub deck firmly with one hand.
2. Push the handle forward with your other hand.
3. Bring the scrub deck slowly down to the floor.
4. Stand behind the NB100.
5. Choose your cleaning mode via the mode buttons/switches as shown in FIG.6 after pressing down the main On/Off switch first at the rear side of the control panel as shown in FIG.6, meanwhile, the battery indicator will illuminate.
6. Hold the handle with both hands.
7. Walk behind the NB100.
8. Steer by gently turning the handle left or right to move the scrub deck.

### Assist in the use of sales shafts

1. Move the power assist pin to the far left.
2. Rotate the machine back and forth, and insert the fixed end of the spring into the bottom of the slot.
3. Move the power pin shaft back to the far right and clamp the spring.

It will provide a forward thrust during user operation, making the user more effortless.

### Vertical pin shaft usage

1. Move the upright pin and assist pin to the leftmost position.
2. Rotate the machine back and forth, and insert the fixed end of the spring into the bottom of the slot.
3. Pull the upright pin back to the far right and clamp the spring.

It will keep the machine in an upright position, making it convenient for users to temporarily park it during use, and for long-term parking

Not recommended for use, more suitable for parking mode.

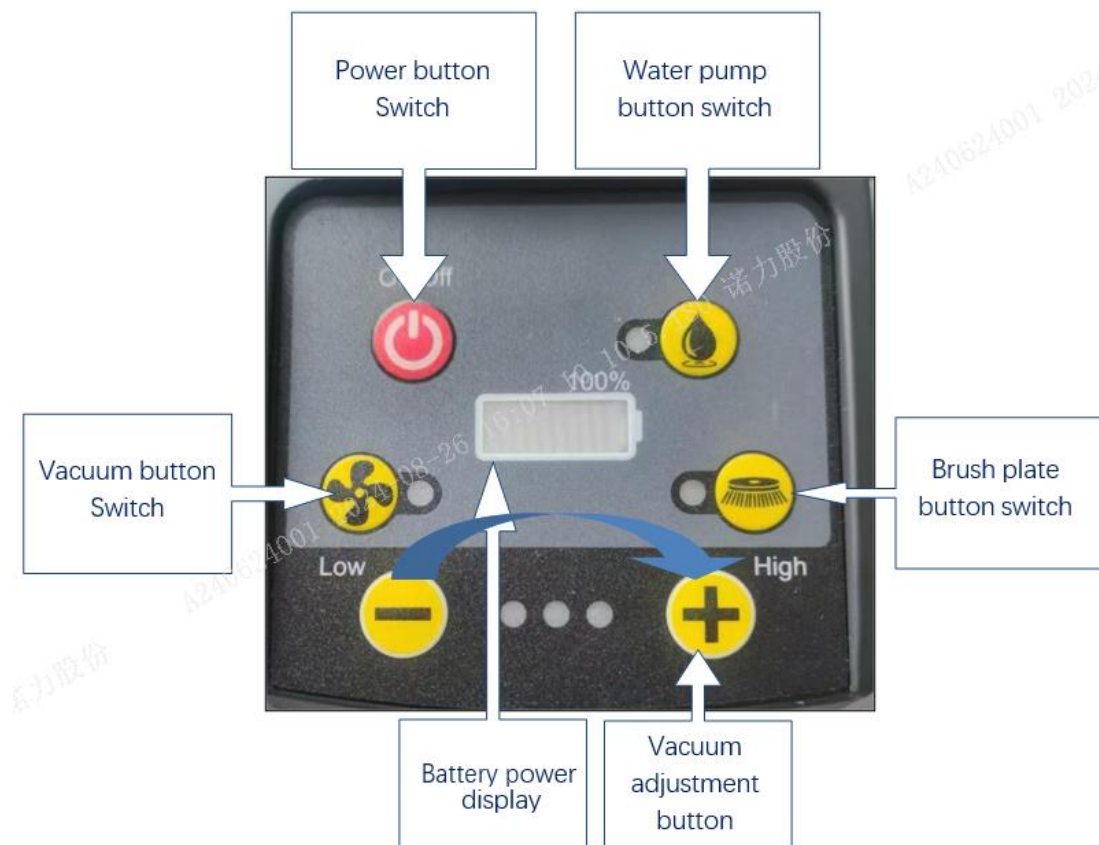

FIG.6

**There are several modes to use the machine:**

**MODE 1:** Vacuum only (Pressing down the Vacuum button only), the product will not move forward automatically.

**MODE 2:** Brush only (Pressing down the Brush button only). the product will move forward automatically

**MODE 3:** Water/cleaning solution only (Pressing down the water pump button only), the product will not move forward automatically.

**MODE 4:** Vacuum + brush (Pressing down both the vacuum button and the brush button),

**MODE 5:** Vacuum + water/cleaning solution (Pressing down both the left button and the right button).

**MODE 6:** Brush + water/cleaning solution (Pressing down both the middle button and the right button), the product will not move forward automatically.

**MODE 7:** Brush + water/cleaning solution+ Vacuum (Pressing down all 3 buttons), the product will move forward automatically and cleaning the floor with water cleaning and vacuum automatically.

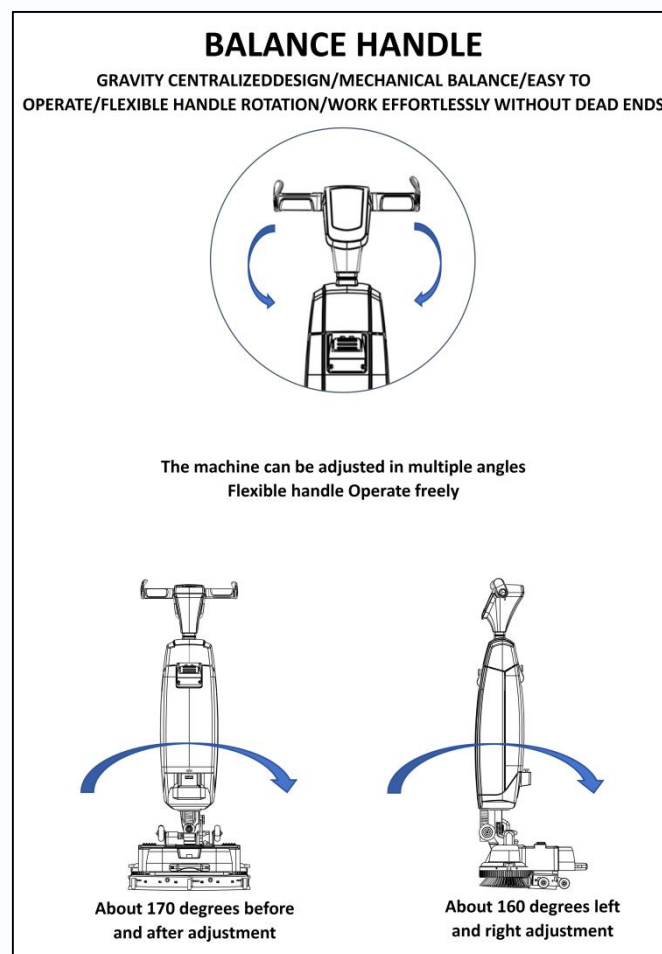

FIG.7

### Stopping the Machine

There are several ways to stop the machine:

1. Press water cleaning button to stop the water releasing.
2. Press brush button to stop the brush (we recommend continuous move forward 5~8m to keep cleaning activities).
3. Press vacuum button to stop the vacuum.
4. Press power off.

**Note:** Releasing the main on/off switch will immediately stop the NB100. But due to the water releasing more on the floor, we recommend you first stop the water cleaning button, and continuous forward 5~8m to keep your floor cleaning and no any dust or water leave on the floor).

**⚠ WARNING:** Do not operate the NB100 at greater than arm's length. Operating below a 45-degree angle can cause water to run into the vacuum engine.

**⚠ WARNING:** Dispose water or cleaning solution from both tanks in an appropriate drain. Even though the recovery tank is bigger, empty it each time the cleaning solution tank is filled.

**⚠ WARNING:** Please observe the local provisions regarding solution disposal related to wastewater treatment.

**⚠ WARNING:** Flush the system Be sure to flush the tanks out completely. To thoroughly flush out any solution in the lines and vales.

### Cleaning and storage

1. Refill solution tank with 0.5 to 1 liter of clean water.
2. Use the NB100 main on/off switch and choose MODE 7 Brush + Water/Cleaning solution + Dry vacuum by pressing all the 3 Switches.

#### Cleaning the tanks

1. Dispose water or cleaning solution from both tanks in an appropriate drain.
2. To clean the recovery tank thoroughly:
  - 1)Partially fill the tank with fresh water and hold it horizontally with the holes facing up.
  - 2)Tilt the tank repeatedly, thoroughly rinsing all the dirt and debris out from the tank.
3. To clean the solution tank, follow the same procedure. (TIP: Dry the tanks)



### Before storage

**Note:** Slightly open both tank caps before storage to allow the tanks to dry.

Check the brushes and squeegee:

1. Check to see if both brushes are clean and intact.  
Clean the under fresh water or replace them if necessary.  
Replace brushes if the yellow wear indicator is the same height as other bristles.
2. Check to see if the squeegee is clean and intact.  
Clean it with fresh water and wipe it with a clean, damp cloth.  
Replace the squeegee blades when necessary.

### Store in an upright position

1. Please ensure that the NB100 is parked in a place where nobody can bump into it.
2. Put the NB100 in the park position.
3. Store the NB100 close to a wall with the handle pointing towards the wall and the brushes facing away from the wall.

## Transportation

**⚠CAUTION:** Be aware of the weight of the machine during the transportation.

### When outside:

1. Put the NB100 in park position.
2. Carry the NB100 with one hand while holding the handle with your other hand.
3. The transport wheels are not designed to roll over dirty surfaces, sand can cause the wheels to block. Lift the NB100 going from one building to another.

## Assembly and installation

The NB100 almost does not require the assembly, you will have to get the wire connectors inserted in place in the battery pack box after taking the machine from the box.

### Unboxing

The NB100 with one charger and 2 tool sets are packed in a box. One charger and one wrench and one hexagon screw wrench are included.

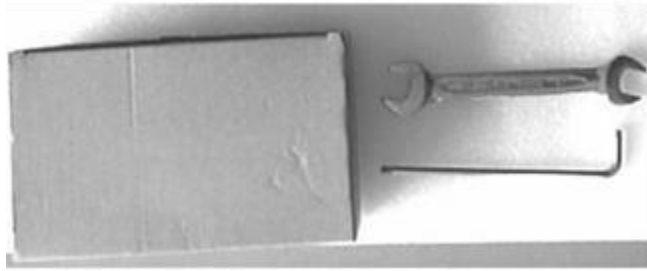

FIG.8

## Charging port location

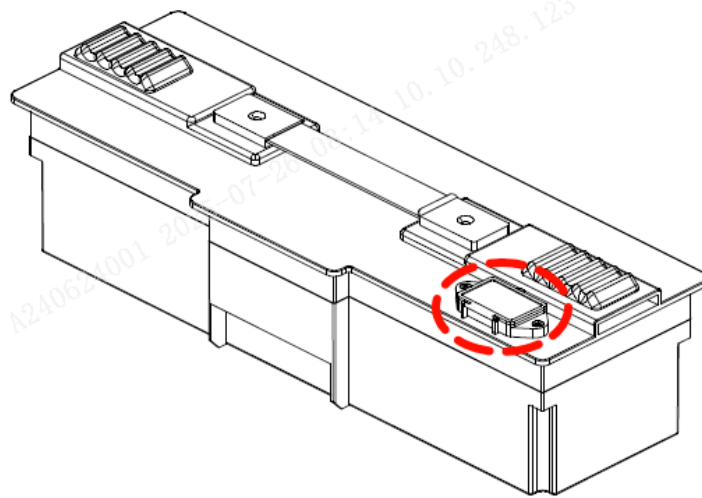

FIG.9

## Maintenance

The machine needs to be maintained regularly to keep the best of the performance and the service life.

**For safety:** Before maintaining or leaving the machine, stop on the level ground and turn off the machine.

## Brushes Replacement

**For safety:** Before maintaining or leaving the machine, stop on the level ground and turn off the machine.

1. Put the NB100 in the park position.
2. The brushes connect on the machine by magnetic force. So simply grab the left and right side of the brushes (stripping pads holder) by two hands and pull the brush out against machine.
3. Visually inspect the motor disks.
4. Clean the NB100 scrub deck with a clean, dry cloth before you install the brushes or stripping pads holder.

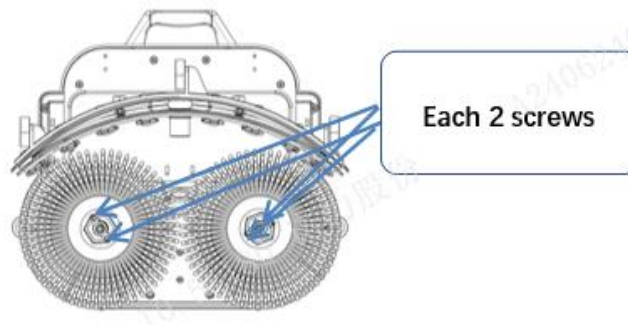

FIG.10

## Squeegee Maintenance

For keeping the best cleaning performance, please clean the blade daily. If squeegee leaves narrow streaks or water, the blades may be dirty or damaged. Remove the squeegee and inspect the blades, rinse them using clean water if they are dirty. Replace or reverse the blades if they are damaged, worn or wavy.

**For safety:** Before maintaining or leaving the machine, stop on the level ground and turn off the machine.

1. Remove the squeegee from the machine.  
To remove the squeegee, the steps should be followed as below:

- 1) Put the NB100 in the park position.
- 2) Hold the scrub deck firmly with one hand.
- 3) Remove the two handle bolts counterclockwise by hand (refer to the nether image).
- 4) Pull out the squeegee properly.
- 5) Remove the vacuum hose from the squeegee by twisting the hose.

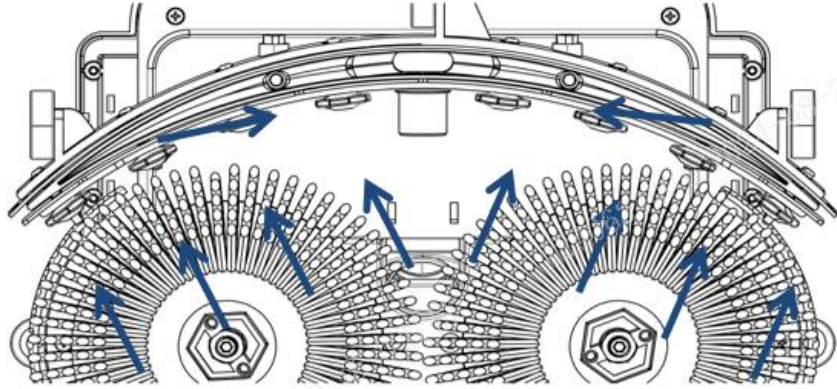

FIG.11

2. Replace or reverse the blades if necessary.
  - 1) Unscrew the 8 plastic nuts on the back (refer to the above image).
  - 2) Take off the squeegee rear plate.
  - 3) Once the plastic part is removed, you can easily take off the rear rubber blade.
  - 4) Push the 8 screws through the front blade in order to remove the squeegee front plate.
  - 5) Take off the rear rubber blade.
  - 6) Inspect the front and rear rubber blades:  
The first time: flip the blades so the top of the blade is now facing the floor. Push the front plate screws through the holes.  
The second time: attach a new set of blades. Push the front plate screws through the holes.

**⚠ CAUTION:** The special squeegee blades that contain small arrow-like shapes cannot be switched. These need to be replaced every time: Put back the plastic rear plate. Screw the 8 plastic nuts on the back.



FIG.12

3. Attach the Squeegee
  - 1) Take the vacuum hose.
  - 2) Insert the hose connector (refer to the above image) in the Squeegee.
  - 3) Twist the hose connector 1/4 turn for a firm fit.
  - 4) Carefully pull the vacuum hose from the top of the machine.
  - 5) Hold the scrub deck firmly with one hand.
  - 6) Align the pins on the scrub deck with the holes on the squeegee.
  - 7) Screw the squeegee in place.
4. Replace vacuum hose
  - 1) Detach the squeegee as described in above sections.
  - 2) Remove the solution tank. You can see where the vacuum hose is connected at the NB100 handle.
  - 3) Hold the scrub deck firmly with one hand,
  - 4) Detach the vacuum hose
  - 5) Now you can carefully pull the vacuum hose from the top of the machine.
  - 6) Guide the new vacuum hose via the opening to the hose connector located at the NB100 handle.
  - 7) Connect the top to the hose connector by twisting the clockwise 1/4 turn until they have lined up.
  - 8) Reinstall the squeegee.

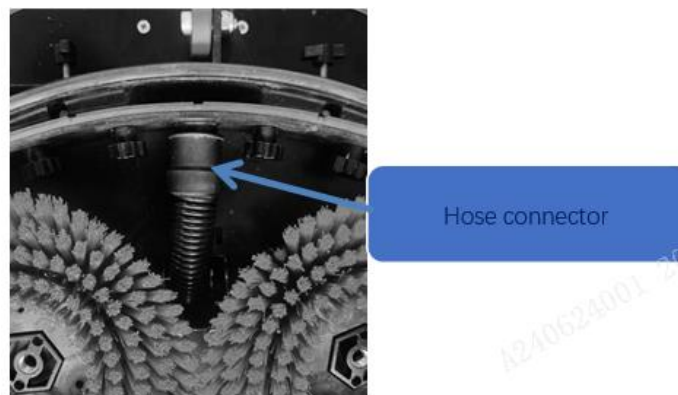

**FIG.13**

### Troubleshooting

PROBLEM	POSSIBLE CAUSE	SOLUTION
No power	No Battery pack	Put battery pack
	Empty battery pack	Charge battery pack
	Battery pack incorrectly connected	Reconnect battery pack
Insufficient/no water flow	Wrong switch on	Check the switch button on the control panel
	Main on/off switch is "off"	Check the main on/off switch
	Empty tank	Fill the tank
	Tank incorrectly placed	The tank valve must be clicked on the nipple to open the seal, replace the tank
	Filter blocked	Ensure the solution tank have no dirt particles and the filter is clean
	Blocked water Pipe	Request for service
Poor water recovery	Squeegee opening blocked	Remove the pipe and clean the squeegee opening
	Tears in squeegee blades	Replace squeegee blades
	Filter blocked	Check the foam filter and clean if necessary
	Vacuum hose blocked	Check and remove blockage
	Vacuum motor not running	Request for service
leakage	Tanks incorrectly placed	Check and reattach fluid tanks
	Tear in vacuum hose	Replace vacuum hose or request for service
Battery not	Battery is at end of life	Replace battery

### Specifications

#### NB100 Specifications

<b>DIMENSIONS</b>	
Length	1155 mm   45.5 in
Width	450 mm   17.7 in
Height (main body)	380 mm   15.0 in
Gross Weight	26.5 Kg   58.4 lbs
Battery Weight	2.8Kg   6.2 lbs
Net Weight	18.5kg   40.8 lbs
Brusher Dimension	212 mm   20 in
<b>CLEANING</b>	
Max. Theoretical Productivity	800m <sup>2</sup> /hr   2986.65 ft <sup>2</sup> /hr
Brush Pressure	6 Kg
Disk Brush Speed	0-350 RPM/min
<b>POWER</b>	
Battery Type	Lithium Iron Phosphate
Battery Capacity	12 Ah
Battery Voltage	36 VDC
Brush Motor Power	120W
Vacuum Motor Power	150W
Vacuum Degree	>10KPa
Battery Working Hours	78mins
<b>NOISE</b>	65±3DB
<b>CAPACITY</b>	
Detergent Tank Capacity	4L(Max)
Recovery Tank Capacity	6L(Max)

Machine Dimensions

